

TOGGLE CLAMPS

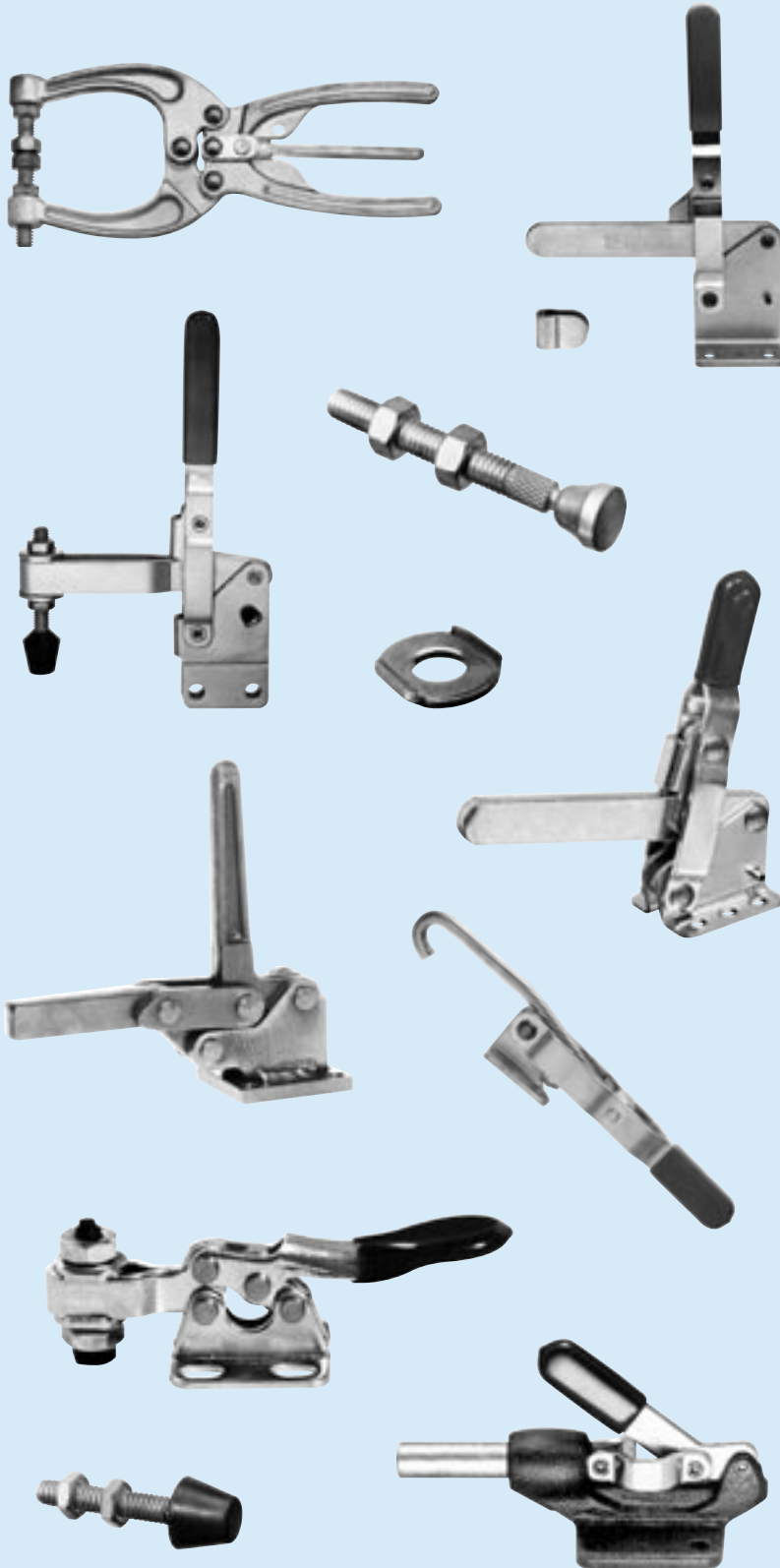

Holding Pressure Competitor Conversion Index	114
General Information	114
Hold Down Action	
Vertical Handle.....	115-119
Horizontal Handle	120-122
Toggle Pliers	123-124
Straight Line Action	125-128
Pull Action	129-130
Accessories	
Flanged Washers	131
Bolt Retainers.....	131
Vinyl Coated Spindle Assembly	131
Neoprene Tipped Spindle Assembly	131
Hex Head Spindle Assembly	132
Swivel Foot Spindle Assembly....	132

Holding Pressure Competitor Conversion Index

Some Toggle Clamps may differ dimensionally, but are functionally interchangeable.

Holding Pressure	TE-CO Part No.	Page No.	Carr Lane No.	Jergens No.	DeStaco No.
Toggle Pliers					
200	34201	134	CL-50-PL	70710	–
350	34210	134	CL-150-PL	–	–
700	34230	134	CL-254-PL	70740	54620
700	34231	135	CL-254-PL-2	70745	54627
700	34240	135	CL-454-PL	70750	54630
700	34250	135	CL-550-PL	–	---
Toggle Clamps – Hold Down Action, Horizontal Handle					
60	34101	131	CL-150-HTC	70210	52060
60	34105	131	CL-250-HTC	70230	52050
60	34106	131	CL-251-HTC	70235	52052
200	34110	132	CL-350-HTC	70240	52150
500	34120	132	CL-450-HTC	70250	52250
1000	34130	133	CL-550-HTC	70270	52350
Toggle Clamps – Straight Line Action					
100	34305	137	CL-50-SPC	---	56010
300	34301	136	CL-250-TPC	70120	56040
300	34310	137	CL-150-SPC	70820	56050
500	34340	139	CL-100-PC	70810	–
600	34325	139	CL-275-SPC	–	56200
700	34302	136	CL-350-TPC	70140	56240
800	34320	138	CL-250-SPC	70840	56100
850	34350	139	CL-200-PC	70830	56080
1500	34360	139	CL-300-PC	–	–
2500	34330	138	CL-350-SPC	70860	56300

Holding Pressure	TE-CO Part No.	Page No.	Carr Lane No.	Jergens No.	DeStaco No.
Toggle Clamps – Hold Down Action, Vertical Handle					
100	34001	120	CL-150-VTC	70310	52010
100	34003	120	CL-152-VTC	70320	52012
100	34069	120	CL-11-TC	–	–
100	34081	120	CL-21-TC	–	–
200	34010	120	CL-250-VTC	70330	52020
200	34011	120	CL-251-VTC	70335	52025
200	34012	120	CL-252-VTC	70340	52022
500	34020	121	CL-450-VTC	70380	52070
500	34021	121	CL-451-VTC	70385	52075
500	34022	121	CL-452-VTC	70390	–
500	34023	121	CL-453-VTC	70395	52074
500	34025	121	CL-350-VTC	70350	52080
500	34026	121	CL-351-VTC	70355	52085
750	34030	122	CL-650-VTC	70440	52100
750	34035	122	CL-550-VTC	70420	52101
850	34087	128	CL-301-TC	–	–
1000	34040	123	CL-850-TC	70470	52470
1000	34041	123	CL-750-VTC	–	52471
1000	34065	129	CL-800-VTC	–	–
1200	34050	123	CL-1050-VTC	70490	52670
Toggle Clamps - Pull Action					
360	34420	142	CL-100-PA	–	53230
375	34401	140	CL-250-PA	70570	53510
375	34402	141	CL-251-PA	70580	53515
700	34425	142	CL-200-PA	–	53310
1000	34405	141	CL-350-PA	–	–
2000	34430	142	CL-300-PA	–	53410

General Information

HOLDING CAPACITY

The **holding capacity** listed for each clamp refers to the maximum external force that the clamp can safely resist in its locked position without incurring any permanent deformation. For hold down clamps, holding capacity is measured with the spindle as close as possible to the handle, and will be less at the end of the clamping arm.

CLAMPING FORCE

Clamping force, the amount of force actually applied to the workpiece by closing and locking the clamp, is generally less than the stated holding capacity. This allows the clamp to have ample capacity to resist external machining forces. Actual clamping force depends on many factors including: spindle position, proper spindle height adjustment, type of spindle used, workpiece material, and the clamp's mechanical advantage. In most cases roughly 1/2 of the stated holding capacity can be applied by hand with medium effort.

Hold Down Action Vertical Handle

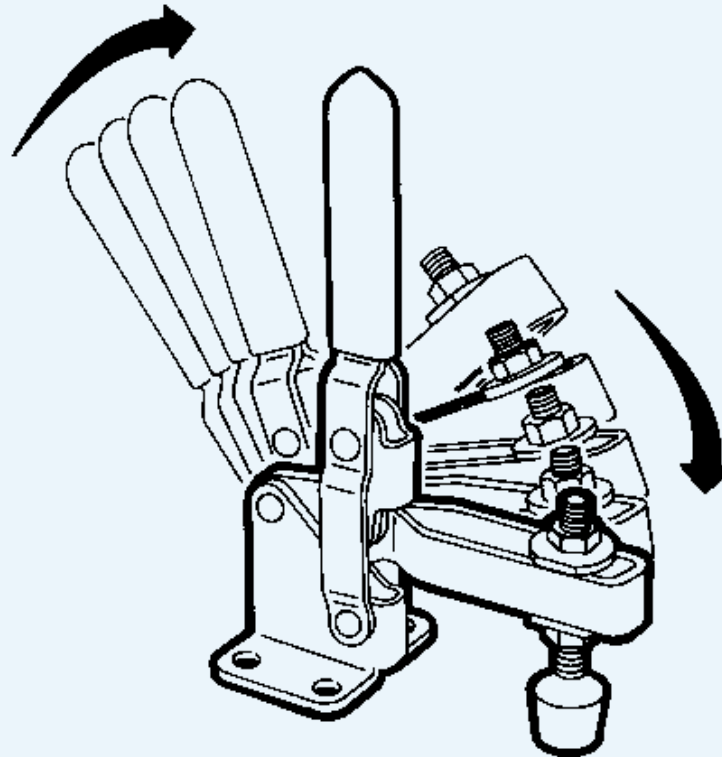

- One of the most popular styles of Toggle Clamps
- U-Bar allows the spindle to be located anywhere on bar length
- Solid Bar allows fixed location of spindle by welding bolt retainer at desired position
- Most clamps include spindle assembly
- Flanged bases provide optimum holding pressure
- Straight bases allow for mounting in limited space
- T-Handles provide greater clearance for machines

All TE-CO Toggle Clamps are interchangeable with industry standards

Hold Down Action Vertical Handle Stainless Steel Part Nos. 34069, 34081

Holding Pressure: 100 lbs.
Handle Moves 83 degrees
Bar Moves 83 degrees

- Miniature clamp in **Stainless Steel**
- Simple easy opening clamps with excellent arm reach, extending farther over workpiece than any other clamps of similar size
- Open arm allows spindle adjustment
- Clamp includes spindle No. 34510
- Weight (lbs/100 pcs): 10

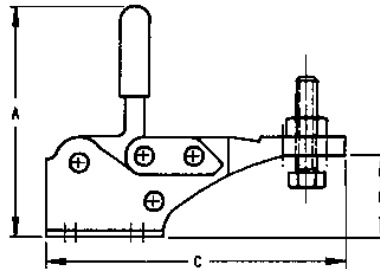
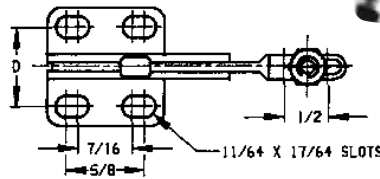
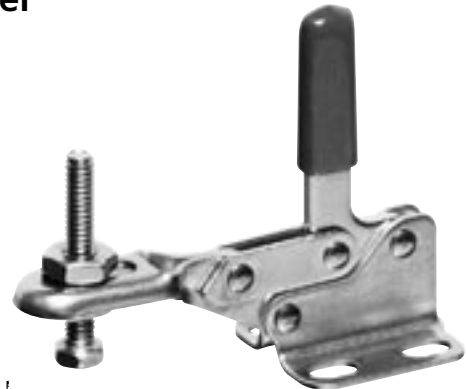

Part No.	A	B	C	D	Base Type
34069	1-13/16	15/32	2-2/8	5/8	Flange
34081	1-3/4	13/16	2-1/16	3/4	Flange

Hold Down Action Vertical Handle Part Nos. 34001, 34003

Holding Pressure: 100 lbs.
Handle Moves 62 degrees
Bar Moves 116 degrees

- Smallest wide opening hold down clamp
- Open arm allows spindle adjustment
- Furnished with two Flanged Washers (Part No. 34501) and Neoprene Tipped Spindle Assembly (Part No. 34534)
- Includes vinyl grip
- Base has 11/64" diameter holes for #8 cap screws.

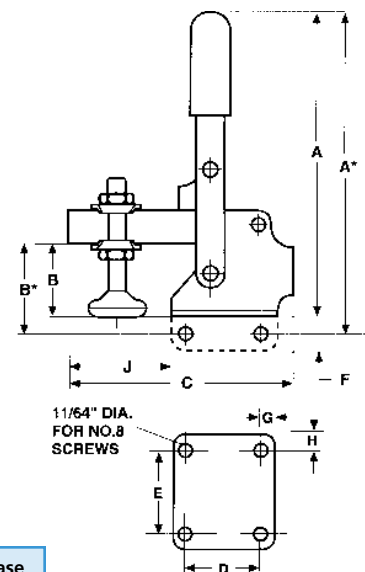
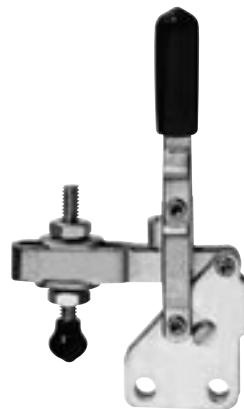

Part No.	A	B	C	D	E	F	G	H	J	Handle Type	Bar Type	Base Type
34001	2-7/8	5/8	2-1/8	5/8	15/16	-	5/16	3/16	1	Vertical	U-Bar	Flange
34003	2-1/4	5/8	2-1/8	5/8	15/16	-	5/16	3/16	1	Tee**	U-Bar	Flange

*Straight base type dimension
** Width of "T": 1-5/8"

Hold Down Action Vertical Handle Part Nos. 34010-12

Holding Pressure: 200 lbs.
Handle Moves 60 degrees
Bar Moves 117 degrees

- Small yet powerful clamp, available in several configurations
- Furnished with Neoprene Tipped Spindle Assembly (Part No. 34530)
- Accepts most 1/4" spindles
- Base has 13/64" diameter holes for #10 cap screws
- Weight (lbs/100 pcs): 40

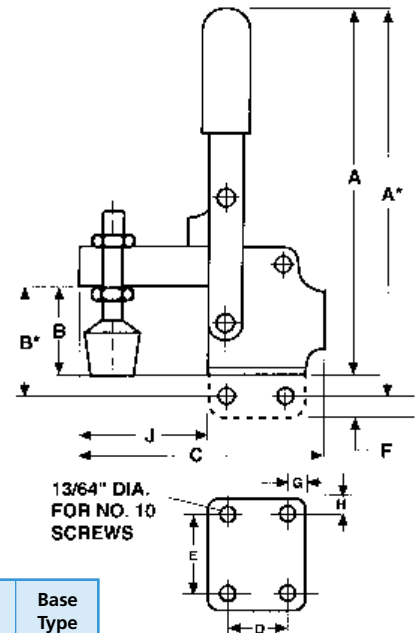
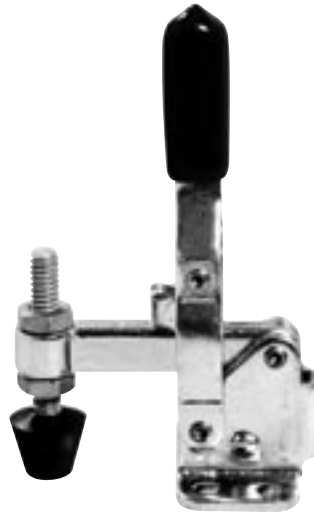

Part No.	A	B	C	D	E	F	G	H	J	Handle Type	Bar Type	Base Type
34010	3-3/4	15/16	2-9/16	1/2	1-1/16	---	1/4	1/4	1-1/16	Vertical	Solid	Flange
34011	3-15/16	1-1/8	2-9/16	1/2	---	7/16	1/4	1/4	1-1/16	Vertical	Solid	Straight
34012	2-13/16	15/16	2-9/16	1/2	1-1/16	---	1/4	1/4	1-1/16	Tee**	Solid	Flange

*Straight base type dimension
** Width of "T": 2-9/16"

Hold Down Action Vertical Handle Part Nos. 34020-26

Holding Pressure: 500 lbs.
Handle Moves 60 degrees
Bar Moves 100 degrees

- U-Bar type is furnished with (2) Flanged Washers (Part No. 34504)
- Solid bar type is furnished with Bolt Retainer (Part No. 34550)
- Includes vinyl grip
- Base has 9/32" diameter holes for 1/4" cap screws
- Weight (lbs/100 pcs): 80

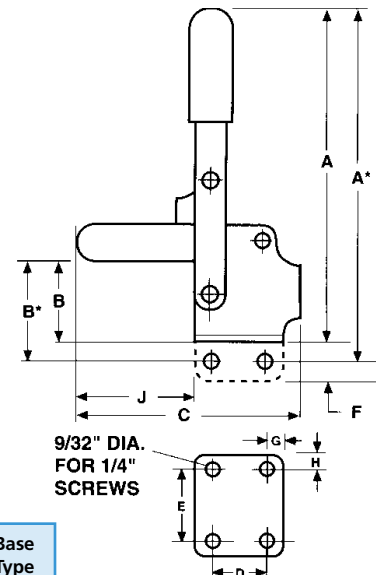
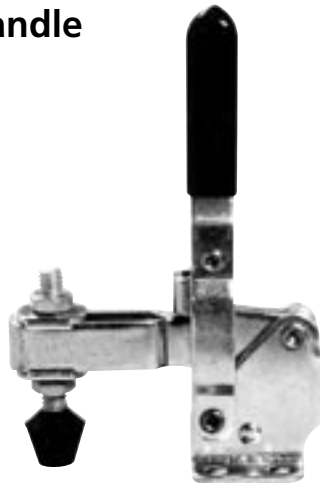

Part No.	A	B	C	D	E	F	G	H	J	Handle Type	Bar Type	Base Type
34020	5-5/8	1-1/4	4	3/4	1-1/4	---	5/16	1/4	2-1/4	Vertical	U-Bar	Flange
34021	5-15/16	1-9/16	3-5/8	3/4	---	9/16	5/16	1/4	2-1/4	Vertical	U-Bar	Straight
34022	4-1/16	1-1/4	3-5/8	3/4	1-1/4	---	5/16	1/4	2-1/4	Tee**	U-Bar	Flange
34023	5-5/8	1-1/4	5-1/2	3/4	1-1/4	---	5/16	1/4	2-1/4	Vertical	U-Bar	Flange
34025	5-5/8	1-1/4	4	3/4	1-1/4	---	5/16	1/4	2-1/4	Vertical	Solid	Flange
34026	5-5/16	1-9/16	4	3/4	---	9/16	5/16	1/4	2-1/4	Vertical	Solid	Straight

*Straight base type dimension
** Width of "T": 3-5/8"

Hold Down Action Vertical Handle Part Nos. 34030, 34035

Holding Pressure: 750 lbs.

Handle Moves 58 degrees

Bar Moves 106 degrees

- U-Bar type is furnished with (2) Flanged Washers and Spindle Assembly
- Solid Bar type furnished with Bolt Retainer and Neoprene Spindle Assembly
- Accepts most 3/8" spindles
- Includes vinyl grip
- Base has 21/64" diameter holes for 5/16" cap screws
- Weight (lbs/100 pcs): 130

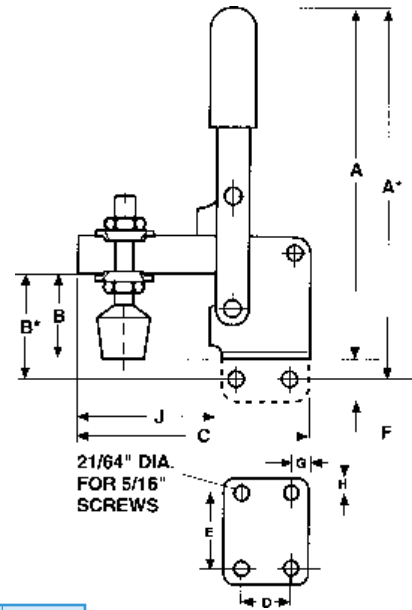
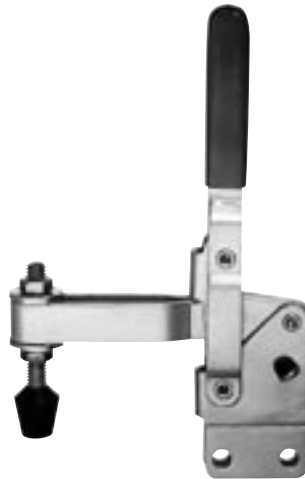

Part No.	A	B	C	D	E	F	G	H	J	Handle Type	Bar Type	Base Type
34030	7-3/4	1-1/16	5-1/2	1-1/4	1-25/32	-	21/64	3/8	3-19/32	Vertical	U-Bar	Flange
34035	7-3/4	1-11/16	5-1/2	1-1/4	1-25/32	-	21/64	3/8	3-19/32	Vertical	Solid	Flange

*Straight base type dimension

** Width of "T": 5"

Hold Down Action Vertical Handle Part Nos. 34040-41

Holding Pressure: 1000 lbs.

Handle Moves 67 degrees

Bar Moves 120 degrees

- Extra large wide opening clamp
- U-Bar is furnished with 2 Flanged Washers (Part No. 34507)
- Solid bar type is furnished with Bolt Retainer (Part No. 34553)
- Accepts most 1/2" Spindle (not included)
- Includes vinyl grip
- Base has 11/32" diameter holes for 5/16" cap screws
- Weight (lbs/100 pcs): 520

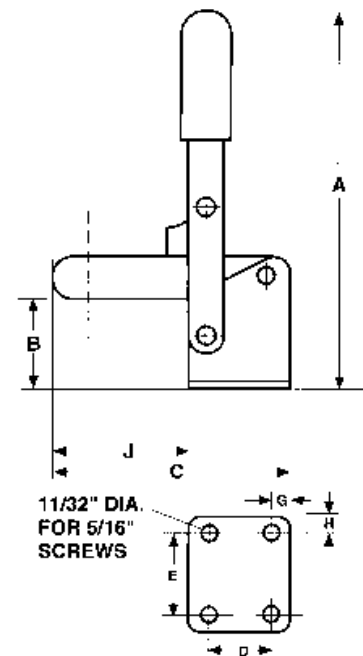

Part No.	A	B	C	D	E	G	H	J	Handle Type	Bar Type	Base Type
34040	9	2	7	1-1/4	1-25/32	3/8	3/8	5	Vertical	U-Bar	Flange
34041	9	2	7	1-1/4	1-25/32	3/8	3/8	5	Vertical	Solid	Flange

Hold Down Action Vertical Handle Part Nos. 34050

- Holding Pressure: 1200 lbs.**
Handle Moves 70 degrees
Bar Moves 140 degrees
- Largest wide opening clamp available
 - U-Bar is furnished with 2 Flanged Washers (Part No. 34507)
 - Solid bar type is furnished with Bolt Retainer (Part No. 34553)
 - Accepts most 5/8" spindles (not included)
 - Includes vinyl grip
 - Base has 1/2" diameter hole for 7/16" cap screws
 - Weight (lbs/100 pcs): 520

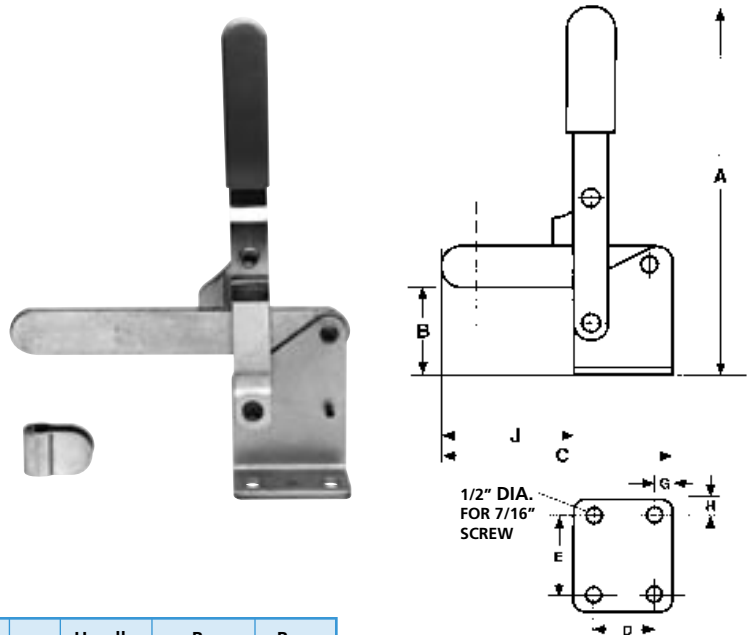

Part No.	A	B	C	D	E	G	H	J	Handle Type	Bar Type	Base Type
34050	12-1/8	3-1/4	9	2	2-3/4	1/2	1/2	5-7/8	Vertical	U-Bar	Flange

Hold Down Action Vertical Handle – High Arm Part No. 34087

- Holding Pressure: 850 lbs.**
Handle Moves 83 degrees
Bar Moves 83 degrees
- Simple, easy opening clamps with extra arm height
 - Accepts most 3/8" spindles
 - Includes vinyl grip
 - Base has 21/64" diameter holes for 5/16" cap screws
 - Weight (lbs/100 pcs): 140

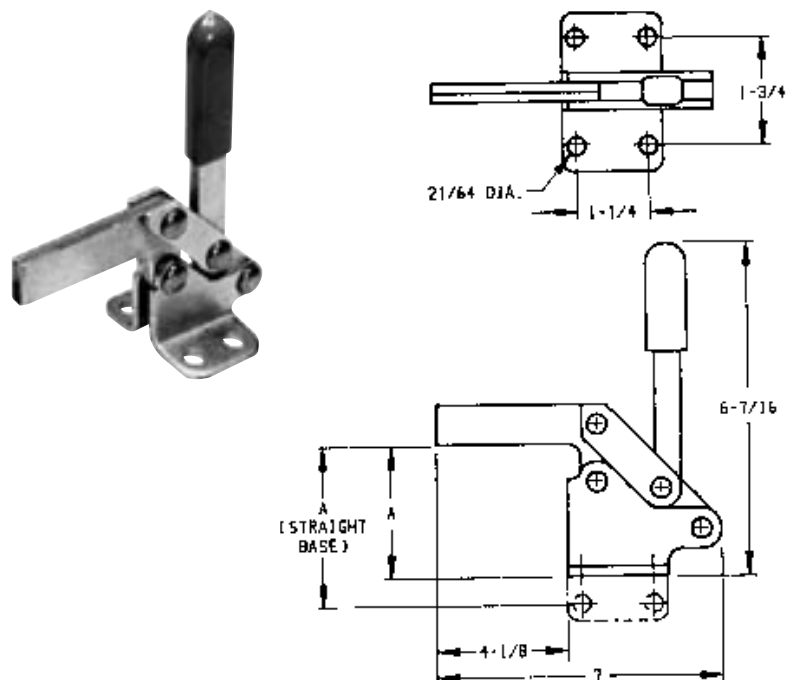

Part No.	A	Base Type	Bar Type
34087	2-1/8	Flange	U-Bar

Hold Down Action Horizontal Handle

- U-Bar allows the spindle to be located anywhere on bar length
- Most clamps supplied with spindle assembly
- Handles stay clear of the workpiece while machining
- Flanged bases provide optimum holding pressure
- Straight bases allow for mounting in limited space

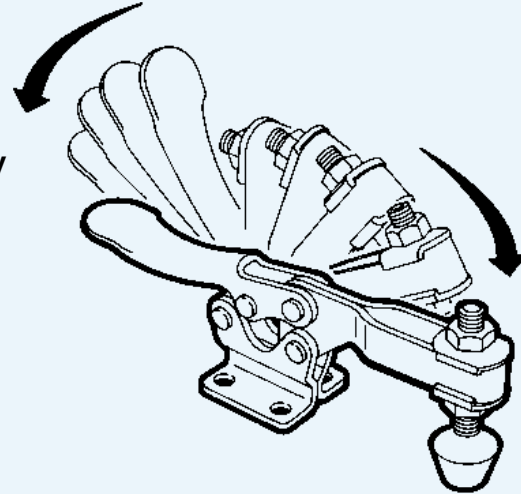

All TE-CO Toggle Clamps are interchangeable with industry standards

Hold Down Action Horizontal Handle Part Nos. 34101, 34105, 34106

Holding Pressure: 60 lbs.
Handle Moves 80 degrees
Bar Moves 90 degrees

- Smallest hold down clamp available
- Furnished with Nylon spindle assembly
- Base has 11/64" x 17/64" slots for #8 cap screws
- Weight (lbs/100 pcs): 10

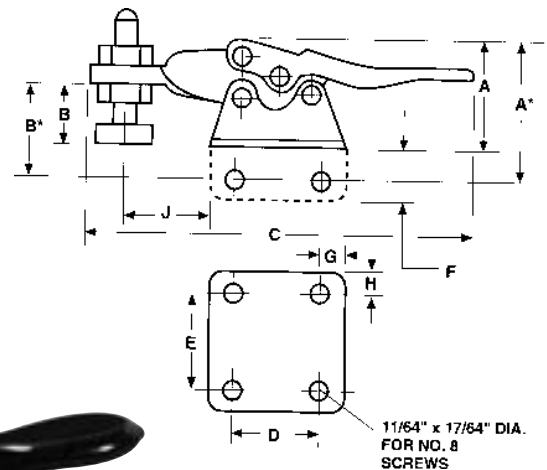

Part No.	A	B	C	D	E	F	G	H	J	Bar Type	Base Type
34101	3/4	13/32	2-3/4	5/8	5/8	-	5/16	5/32	11/16	Solid	Flange
34105	3/4	5/16	2-21/32	5/8	5/8	-	5/16	5/32	11/16	U-Bar	Flange
34106	15/16	1/2	2-21/32	5/8	-	11/32	5/16	5/32	11/16	U-Bar	Straight

Hold Down Action Horizontal Handle Part Nos. 34110

**Holding Pressure: 200 lbs.
Handle Moves 60 degrees
Bar Moves 90 degrees**

- Medium duty clamp with open arm for spindle adjustment
- U-Bar type is supplied with 2 Flanged Washers (Part No. 34503)
- Furnished with Neoprene Tipped Spindle Assembly (Part No. 34530)
- Base has 13/64" diameter holes for 1/4" cap screws
- Weight (lbs/100 pcs): 30

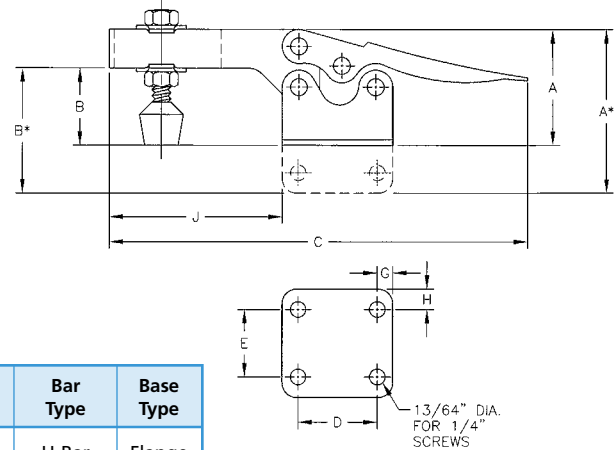

Part No.	A	B	C	D	E	F	G	H	J	Bar Type	Base Type
34110	1-1/2	1	5-7/16	1-1/16	7/8	-	3/16	17/64	2-1/4	U-Bar	Flange

Hold Down Action Horizontal Handle Part Nos. 34120

**Holding Pressure: 500 lbs.
Handle Moves 65 degrees
Bar Moves 90 degrees**

- Most popular horizontal handle clamp with open arm for spindle adjustment
- Furnished with Neoprene Tipped Spindle Assembly (Part No. 34531)
- Base has 17/64" diameter holes for 1/4" cap screws
- Weight (lbs/100 pcs): 60

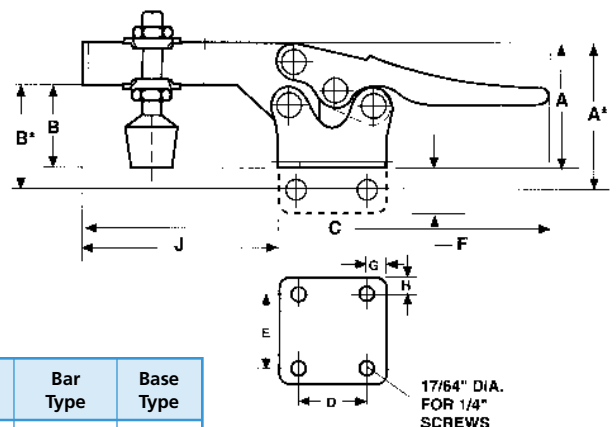

Part No.	A	B	C	D	E	F	G	H	J	Bar Type	Base Type
34120	1-7/8	1-3/8	6-5/8	1	7/8	-	1/4	1/4	2-3/4	U-Bar	Flange

Hold Down Action Horizontal Handle Part Nos. 34130

Holding Pressure: 750 lbs.
Handle Moves 55 degrees
Bar Moves 90 degrees

- Heavy duty clamp with open arm for spindle adjustment
- Furnished with Neoprene Tipped Spindle Assembly (Part No. 34533)
- Includes vinyl grip
- Base has 21/64" diameter holes for 5/16" cap screws
- Weight (lbs/100 pcs): 150

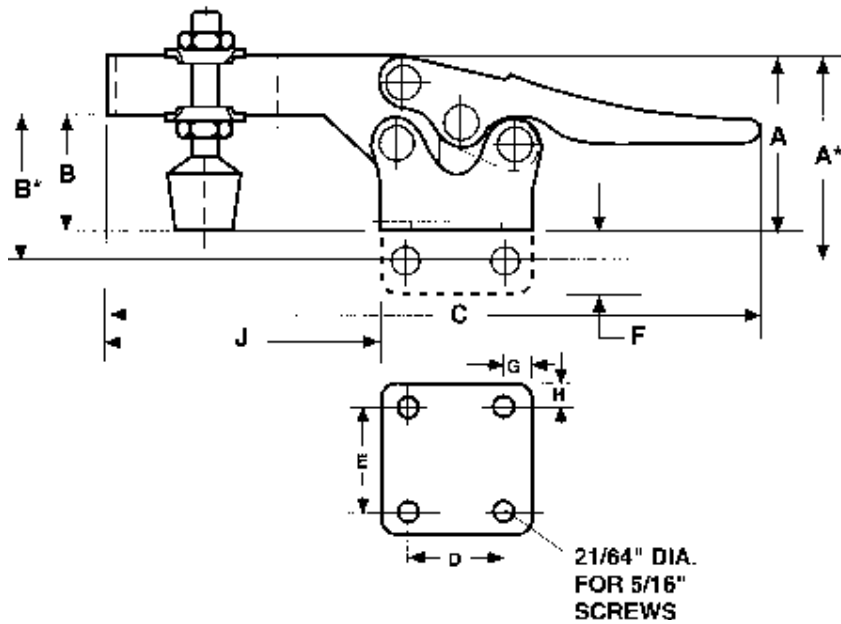

Part No.	A	B	C	D	E	F	G	H	J	Bar Type	Base Type
34130	2-1/2	1-3/4	10-1/4	1-5/8	1-5/8	-	5/16	5/32	4-1/8	U-Bar	Flange

Toggle Pliers Squeeze Action

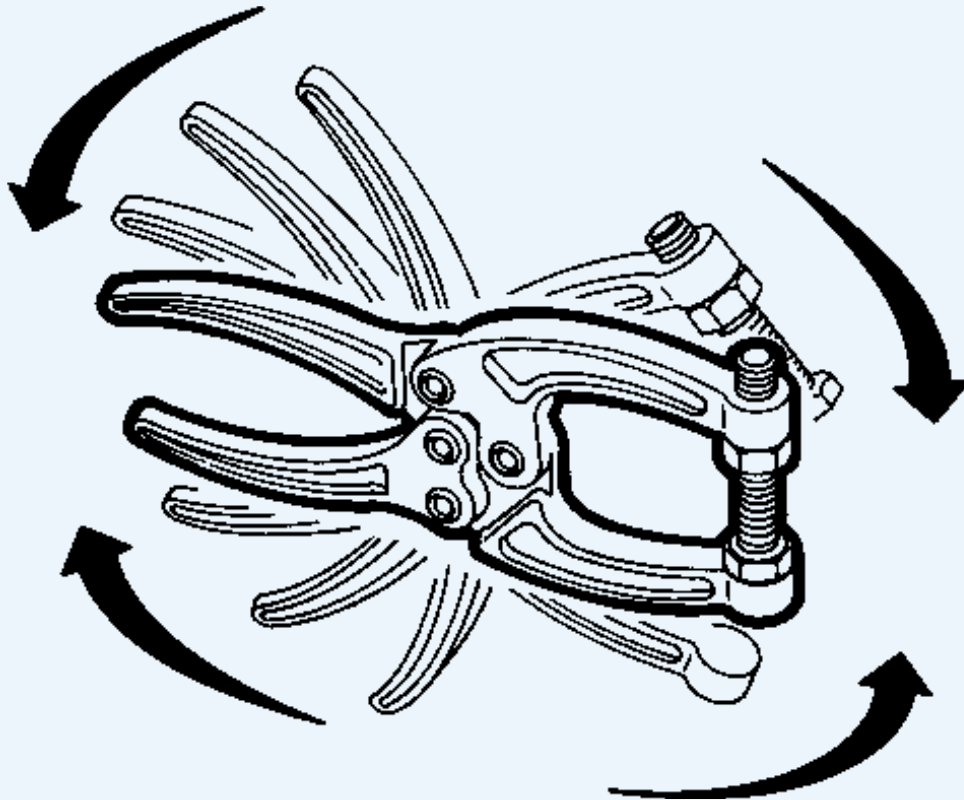

- Many pliers have a two-way trigger release
- Jaws are case hardened
- Pliers supplied with spindle assemblies
- Handles are contoured for comfortable grip
- Wide range of sizes available
- May be used without spindles
- Plier jaw may be welded permanently to fixture for quick clamping

**All TE-CO Toggle Clamps are
interchangeable with industry standards**

Toggle Pliers
Squeeze Action
Single Adjustable Spindle
Part Nos. 34201, 34210, 34230

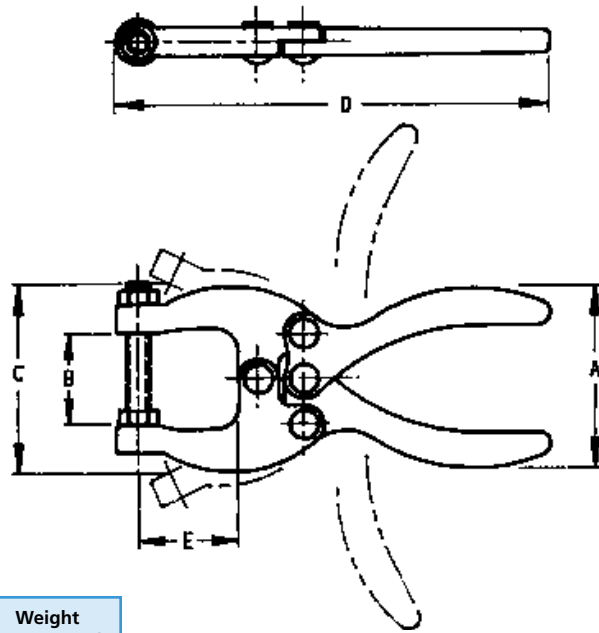

Part No.	A	B	C	D	E	Holding Capacity	Spindle Included	Weight (lbs./100 pcs)
34201	1-5/16	1	2-1/16	4-1/2	1-1/8	200 lbs.	34521	40
34210	1-7/8	1-1/4	2-13/16	6	1-3/4	350 lbs.	34512	50
34230	2-11/16	1-3/4	4-1/4	8-1/2	2-3/4	700 lbs.	34541	130

Toggle Pliers
Squeeze Action
Dual Adjustable Spindles
Part Nos. 34231, 34240, 34250

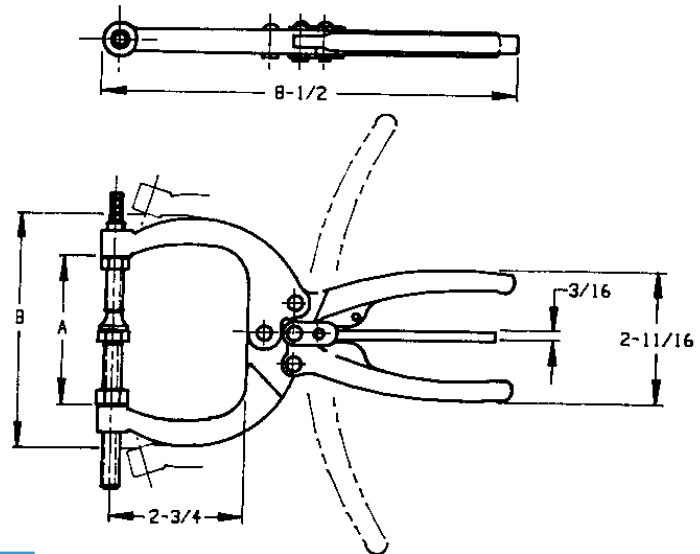

Part No.	A	B	Holding Capacity	Spindle Included	Weight (lbs./100 pcs)
34231	1-3/4	4-1/4	700 lbs.	34514	130
34240	3	4-3/4	700 lbs.	34541 & 34514	140
34250	4-1/4	5-1/4	700 lbs.	34514	160

Straight Line Action

- Clamps provide push/pull forces
- Tapped plunger allow use of a variety of spindles and attachments

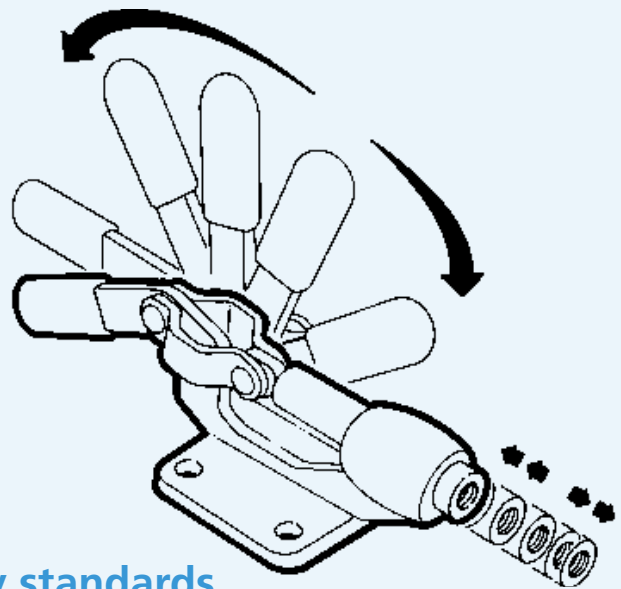

All TE-CO Toggle Clamps are interchangeable with industry standards

Straight Line Action Part Nos. 34300-02

- Clamp can be flush mounted using the hex lock nut or it can be mounted directly into tapped hole; either mounting allows 360 degree clamp rotation
- Clamp locks in forward or reverse position
- Furnished with a hex lock nut and vinyl grip
- Part number 34301 accepts any 5/16-18 spindle
- Part number 34302 accepts any 3/8-16 spindle

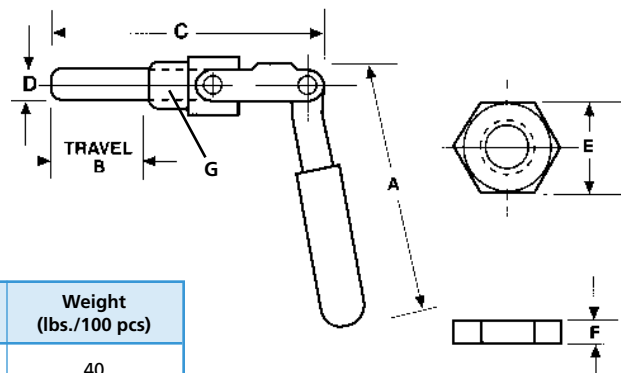
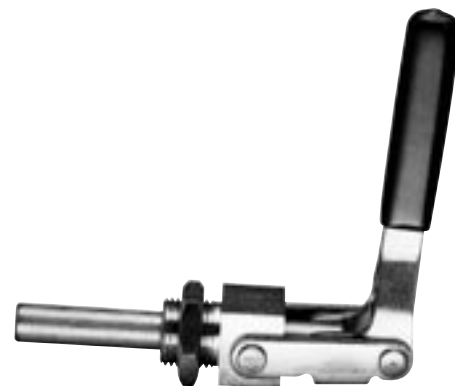

Part No.	A	B	C	D	E	F	G	Spindle Capacity	Weight (lbs./100 pcs)
34300	2-1/2	3/4	2-15/16	3/8	.88	1/4	5/8-18	200 lbs.	40
34301	4-1/4	1-1/2	4-3/4	7/16	1.00	1/4	3/4-16	300 lbs.	70
34302	5-9/16	2-5/8	6-11/16	5/8	1.50	1/4	1-14	700 lbs.	150

TOGGLE CLAMPS

Straight Line Action Part Number 34305

Holding Capacity: 100 lbs.

- Furnished with Hex Head Spindle Assembly (Part No. 34510)
- Weight (lbs/100 pcs): 20

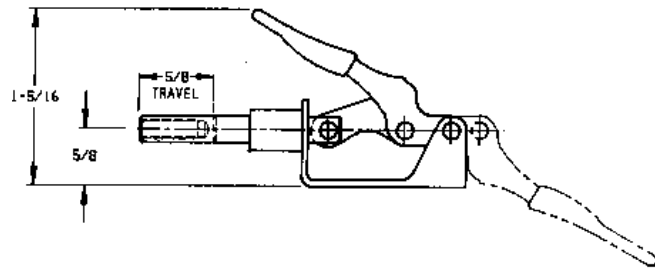
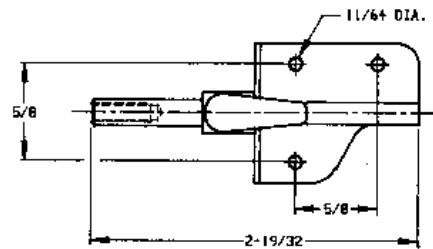

Straight Line Action Part Number 34310

Holding Capacity: 300 lbs.

- Accepts any 5/16-18 spindle
- Weight (lbs/100 pcs): 70

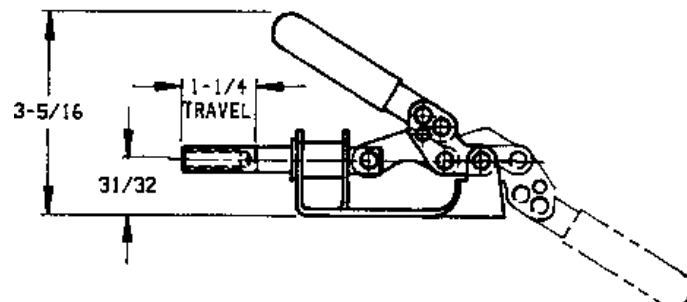
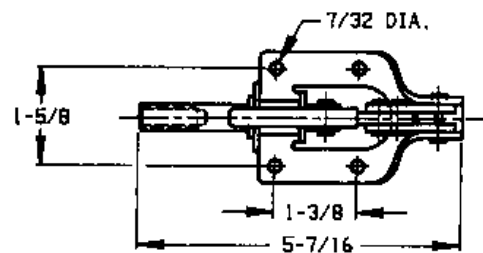

Straight Line Action Part Number 34320

- Holding Capacity: 800 lbs.**
- Accepts any 3/8-16 spindle
 - Weight (lbs/100 pcs): 190

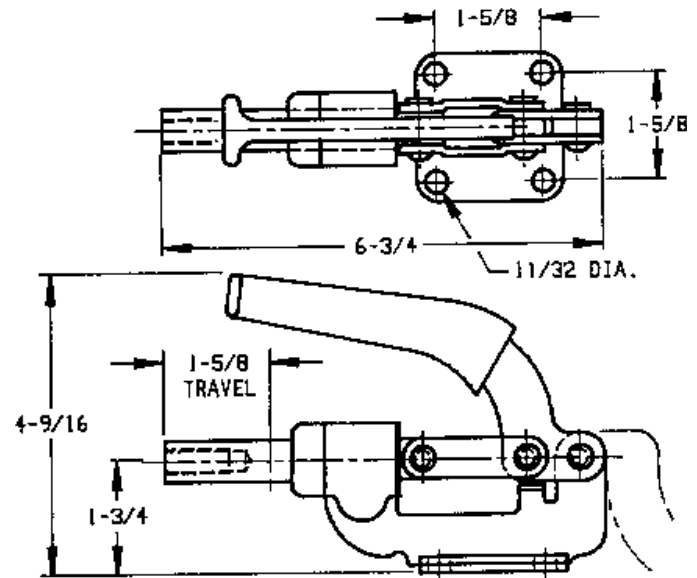

Straight Line Action Part Number 34330

- Holding Capacity: 2500 lbs.**
- Accepts any 3/8-16 spindle
 - Weight (lbs/100 pcs): 200

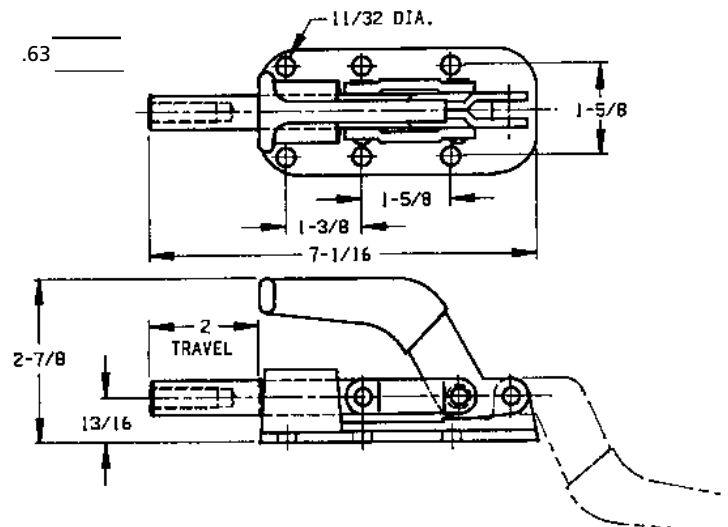

Straight Line Action Part Nos. 34325

Holding Capacity: 600 lbs

- Accepts any 3/8-16 spindle
- Weight (lbs/100 pcs): 150

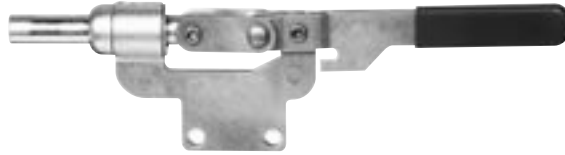

Part No.	A	B	Base Type
34325	2-1/4	1-11/16	Flange

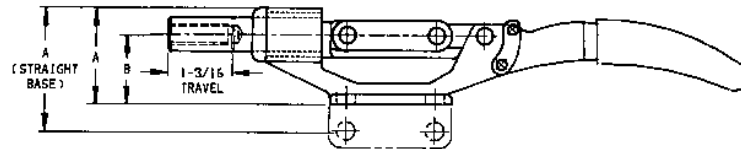
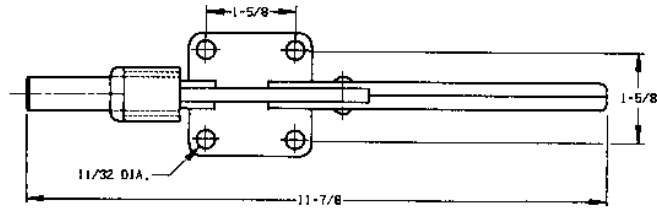

Straight Line Action Part Nos. 34340, 50, 60

- Part number 34340 accepts any 5/16-18 spindle
- Part number 34350 accepts any 3/8-16 spindle
- Part number 34360 accepts any 1/2-13 spindle

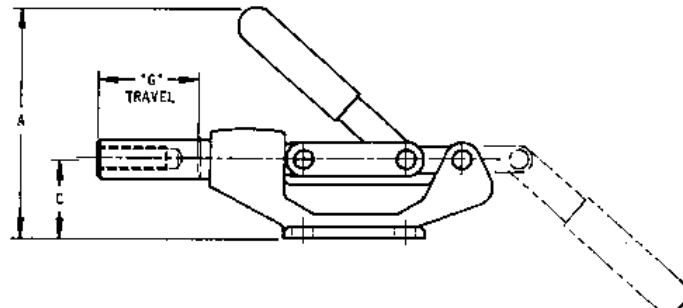
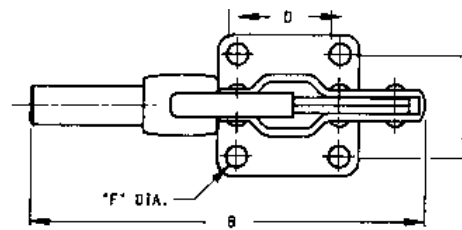
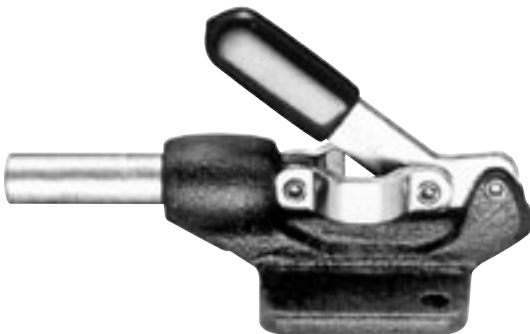

Part No.	A	B	C	D	E	F	Travel G	Holding Capacity	Wt. (lbs./100 pcs)
34340	2-3/16	4-13/16	1	1-3/8	1-5/8	9/32	1-3/16	500 lbs.	90
34350	3-5/8	6-9/32	1-1/4	1-5/8	1-5/8	11/32	1-5/8	850 lbs.	140
34360	5-3/8	9-3/8	1-3/4	2	2	11/32	2-11/32	1500 lbs.	320

Pull Action

Ideal for latching, locking, or fastening doors, fixtures, pressure vessels, covers and hatches on storage tanks

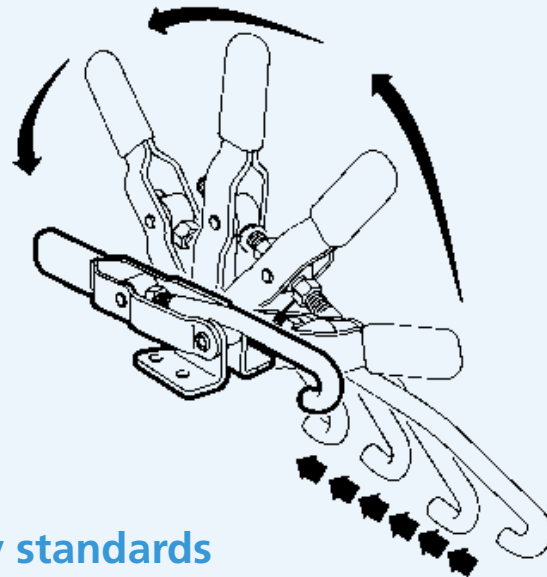

All TE-CO Toggle Clamps are interchangeable with industry standards

Pull Action Part Number 34401

Holding Capacity: 375 lbs.
• Weight (lbs/100 pcs): 80

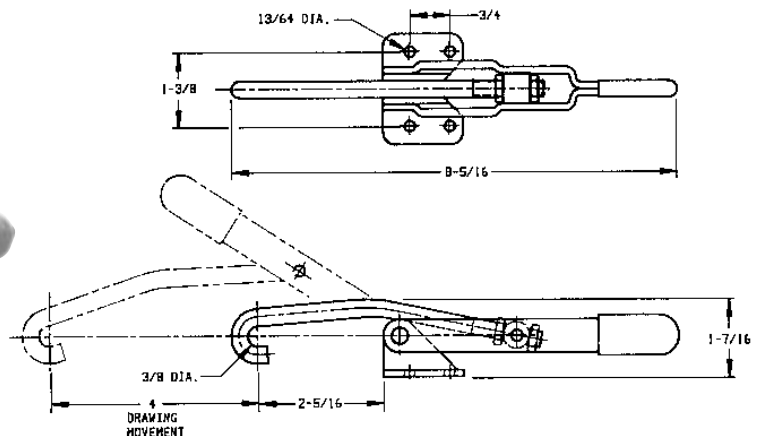

Pull Action (Narrow Base) – Part Number 34402

Holding Capacity: 375 lbs.
• Weight (lbs/100 pcs): 80

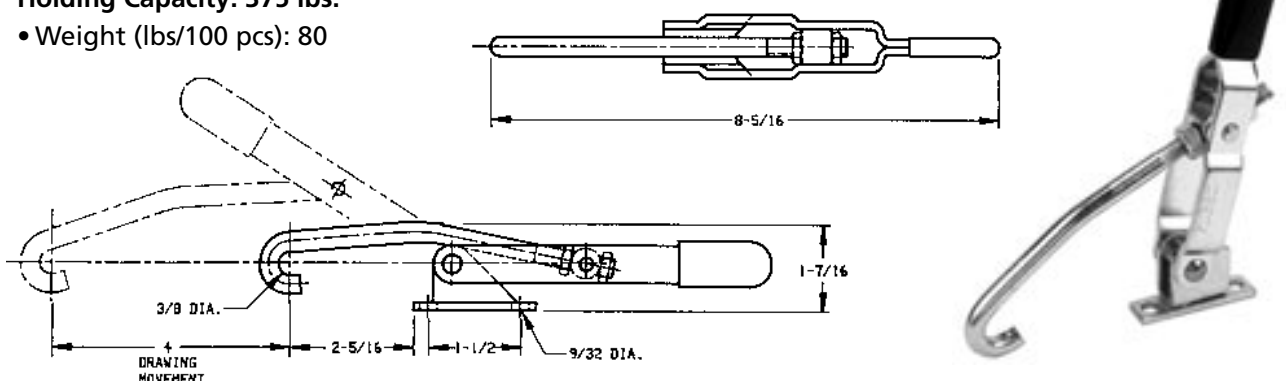

TOGGLE CLAMPS

Pull Action Part Number 34405

Holding Capacity: 1000 lbs.
• Weight (lbs/100 pcs): 250

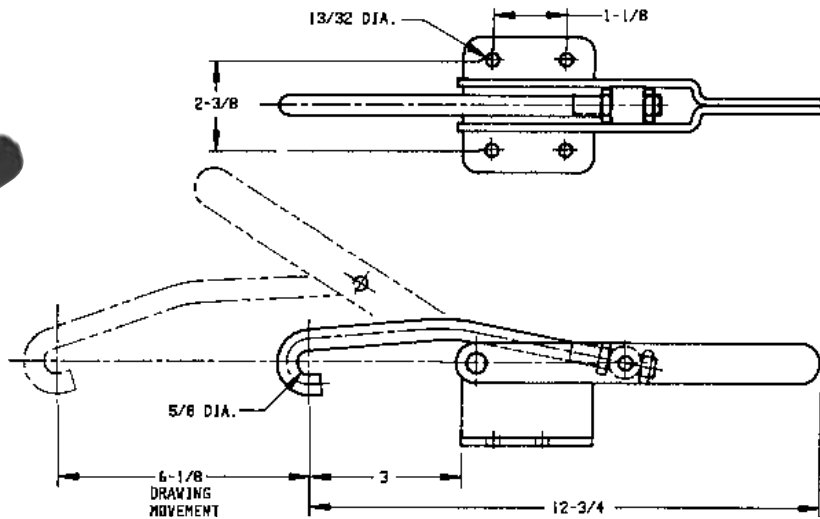
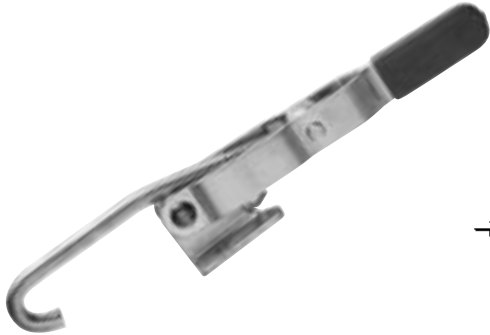

Pull Action Part Nos. 34420, 25, 30

Holding Capacity:
– Part Number 34420: 360 lbs.
– Part Number 34425: 700 lbs.
– Part Number 34430: 2000 lbs.

• Weight (lbs/100 pcs):
– Part Number 34420: 20
– Part Number 34425: 40
– Part Number 34430: 150

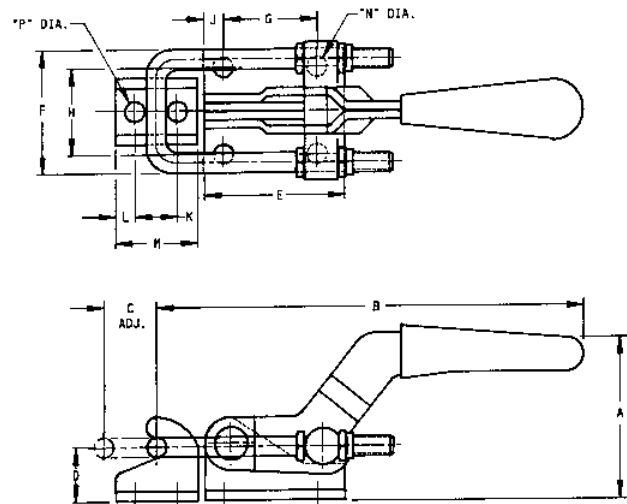

Part No.	A	B	C	D	E	F	G	H	J	K	L	M	N	P
34420	1-5/32	3-15/32	25/64	15/32	1-1/32	1-7/64	5/8	3/4	13/64	25/64	15/64	25/32	11/64	11/64
34425	1-5/8	5-5/8	3/8	21/32	1-9/16	1-3/4	3/4	1-1/4	1/4	9/16	7/32	1	17/64	7/32
34430	2-3/4	7-1/2	15/16	15/16	2-3/8	2-1/8	1-5/8	1-1/2	3/8	3/4	3/8	1-1/2	11/32	11/32

ACCESSORIES

Flanged Washers



Part No.	Spindle Size	Furnished with Clamp No.	May be used with Clamp No.
34501	10-32	34001, 34003	-
34502	8-32	34105, 34106	-
34503	1/4-20	34110	-
34504	5/16-18	34020, 34021, 34022 34023, 34120	-
34505	3/8-16	34030 34130	34087
34506	1/2-13	34040	-
34507	5/8-11	34050	-

Bolt Retainers



Part No.	Spindle Size	Furnished with Clamp No.
34550	5/16-18	34025, 34026
34551	3/8-16	34035
34552	1/2-13	34041

Vinyl Coated Spindle Assembly

- Each assembly includes two Jam Nuts

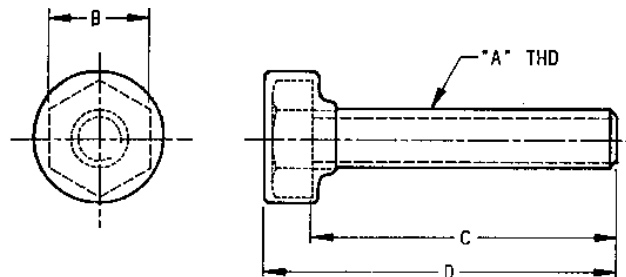

Part No.	A	B	C	D	Furnished with Clamp No.
34521	1/4-20	7/16	1-5/16	1-1/2	34201

Neoprene Tipped Spindle Assembly

- Each assembly includes two Jam Nuts

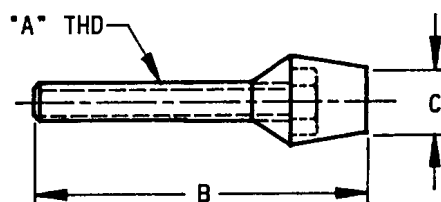

Part No.	Thread A	B	C	Furnished with Clamp No.	May be used with Clamp No.
34530	1/4-20	1-3/4	13/32	34010, 34011, 34012, 34110	-
34531	5/16-18	2	1/2	34120	34020, 34021, 34022, 34023, 34025, 34026
34532	5/16-18	3	1/2	34210	34301, 34310, 34340
34533	3/8-16	3-1/2	5/8	34130	34030, 34035, 34087 34302, 34320, 34325, 34330, 34350
34534	10-32	1-3/8	7/16	34001, 34002	-

ACCESSORIES

Hex Head Spindle Assembly

- Each assembly includes two Jam Nuts

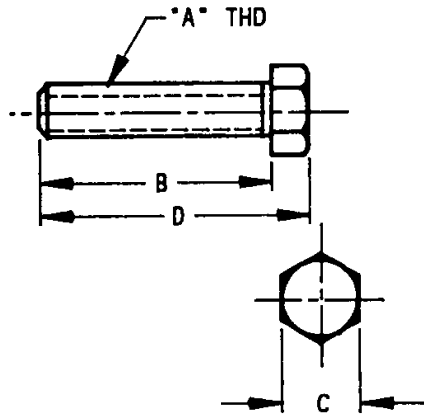

Part No.	Thread A	B	C	D	Furnished with Clamp No.	May be used with Clamp No.
34509*	8-32	1	1/4	1-1/8	34101, 34105 34106, 34305	-
34510	8-32	1	1/4	1-1/8	34069, 34081	-
34512	5/16-18	2-1/2	1/2	2-11/16	34210	34020, 34021, 34022 34023, 34025, 34026
34514	3/8-16	3-1/4	9/16	3-1/4	34231, 34240 34250	34030, 34035 34087, 34320, 34325 34330, 34350
34515	1/2-13	3	3/4	3-5/16	-	34040-34041-34360
34516	5/8-11	4	15/16	4-3/8	-	34050

*Nylon Hex Head Spindle Assembly

Swivel Foot Spindle Assembly

- Each assembly includes two Jam Nuts

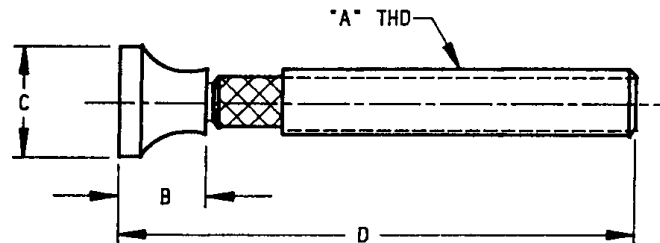
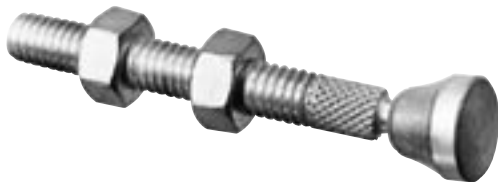

Part No.	A	B	C	D	Furnished with Clamp No.	May be used with Clamp No.
34540	5/16-18	7/16	9/16	2-3/4	-	34020, 34021, 34022 34023, 34025, 34026 34301, 34310, 34340
34541	3/8-16	1/2	5/8	2-1/2	34320, 34240	34030, 34035, 34087, 34302, 34320, 34325, 34330, 34350